

电压/Main voltage: 3VDC、6VDC、9VDC、12VDC、24VDC、36VDC

用途/Typical applications: 自动百叶窗、捆钞机、装订机、移动电视机架、包装机、机器人、纸巾机、办公设备、家用设备、执行器  
Auto shutter, Money detector, Binding machine, Automatic TV rack, Packing bank note machine, Towel dispensers, Tissue machine, Office equipment, Household appliances, Automatic actuator.

重量/Weight: 350~400g/pcs(approx)

包装外形尺寸/Packing details: CTN size: 37X35.5X17cm 12pcs/CTN G.W.12kgs

外形尺寸 APPEARANCE SIZE

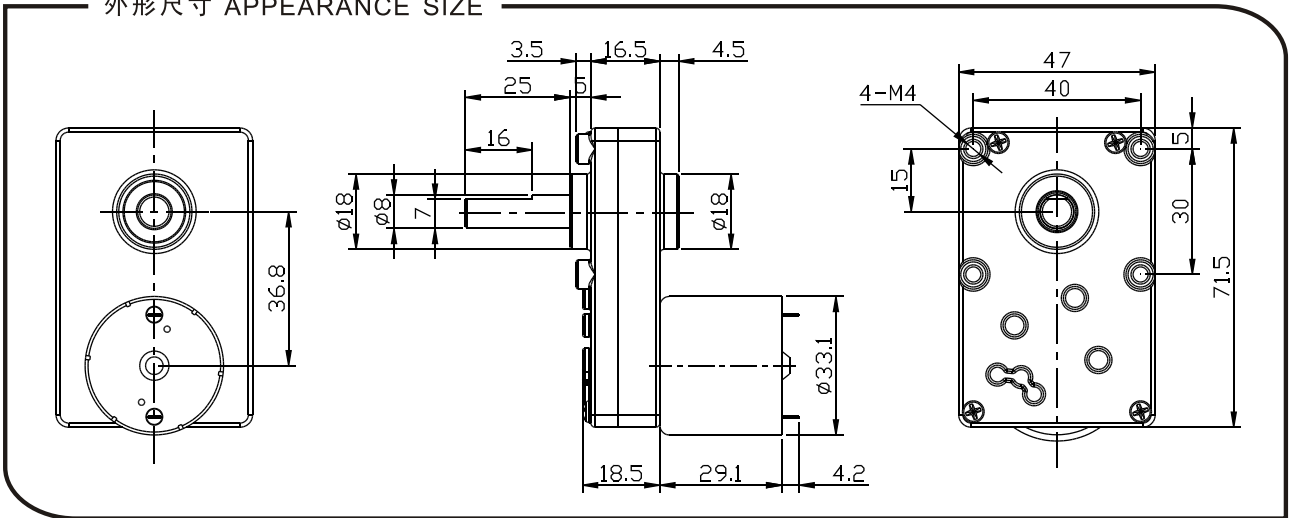

齿轮箱数据 Gearbox data

减速箱级数 Number of stages	3 减速比 Stages reduction	4 减速比 Stages reduction	5 减速比 Stages reduction
减速比 Reduction ratio	73	135、252	391、506、730
最大运转力矩 Max. Running torque	10kgf.cm	20kgf.cm	30kgf.cm
最大破坏力矩 Max. Gear breking torque	30kgf.cm	60kgf.cm	90kgf.cm
最高齿轮效率 Max. Gearing efficiency	73%	65%	59%

其它减速比请致电或邮件给我司技术部 Other reduction ratio please telephone or e-mail to our engineering department.

马达参数 Motor data

马达型号 Motor Model	电压 Rated Volt. V	空载 No load		负载 Load torque				堵转 Stall torque	
		电流 Current	转速 Speed	电流 Current	转速 Speed	扭矩 Torque	输出功率 Output power	扭矩 Torque	电流 Current
		mA	r/min	mA	r/min	gf.cm	W	gf.cm	MA
VG-38123400	12	≤40	3400	≤180	2500	40	1.0	160	720
VG-38124500	12	≤60	4500	≤350	3300	60	2.0	210	1400
VG-38126000	12	≤70	6000	≤720	4500	80	3.6	300	2800
VG-38243000	24	≤15	3000	≤80	2200	40	0.9	140	320
VG-38244500	24	≤25	4500	≤180	3300	60	2.0	210	730
VG-38246700	24	≤45	6700	≤360	4500	80	3.6	300	1400

- 这张表格只列出部分电机参数，想了解更多具体参数请参照93页。
- This table lists some motors parameters, otheers please refer to specific parameters of Page 93.
- 马达和齿轮箱装配成减速电机后输出扭矩 = 马达扭矩X减速比X齿轮效率;输出转速 = 马达转速 / 减速比。
- After connecting motor and gearbox which is named gearmotor the output torque: motor torque X reduction ratio X gearing efficiency; output speed: motor speed/reduction ratio.